



VICTOR STERLYN SALOME
RNC PERSONA FISICA: 02601298363

Compañía dedicada a la construcción y remodelación de estructuras metálicas y hormigón armado, creación de presupuestos, diseño de estructuras, sistemas de drenaje, cristalería, entre otros, con la mas alta calidad del mercado.
Tel (829) 446-0188 / Offi (829) 873-0188

FICHA TECNICA



Características y Beneficios

- Frente de acero inoxidable, lados, respaldo, alto estante de elevación.
- 6 "patas ajustables de acero inoxidable.
- Quemadores superiores abiertos de 28,000 BTU / h con cabezales elevables.
- Sistema piloto de tubo de flash envuelto (un piloto por cada dos quemadores).
- Rejillas de fundición de 12 "x 12" con tazones de aireación.
- medidas estándar de la cavidad del horno de 30,000 BTU / h
- 26 3/4 "de ancho x 26" de profundidad x 13 3/4 "de altura.
- El termostato del horno se ajusta de 250 ° a 500 ° F.
- Un bastidor de horno y cuatro posiciones de bastidor.
- Conexión de gas trasera de 3/4 "y regulador de presión de gas.



Ing. Victor Sterlyn Salome



CATALOG OF REPLACEMENT PARTS

VESTA SX36/SX60/SX60F RANGE

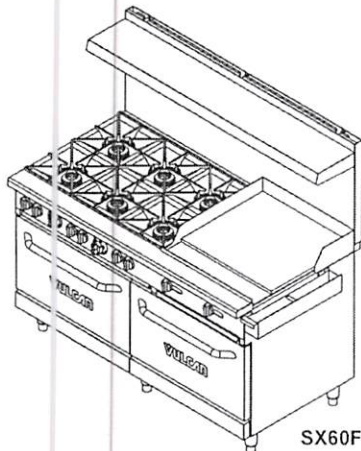



Table of Contents

DOOR	5
COVERS (SX36)	7
COVERS (SX60 / SX60F)	9
OVEN	11
PIPING	13
GRIDDLE	15





PL 65027

DOOR

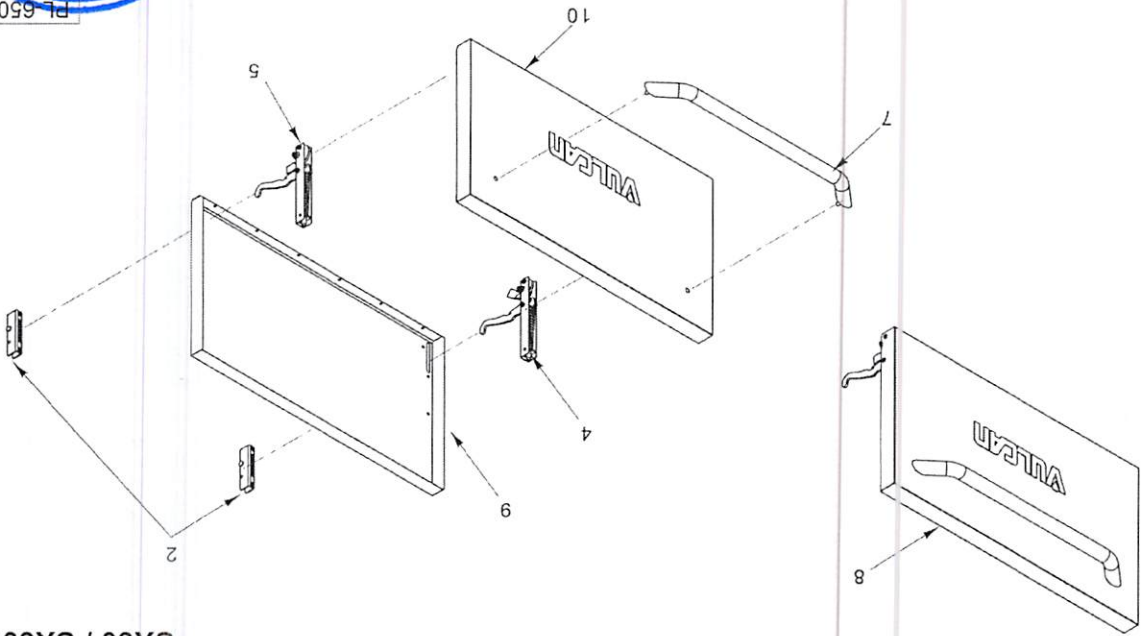

SX60 / SX60F

SX36

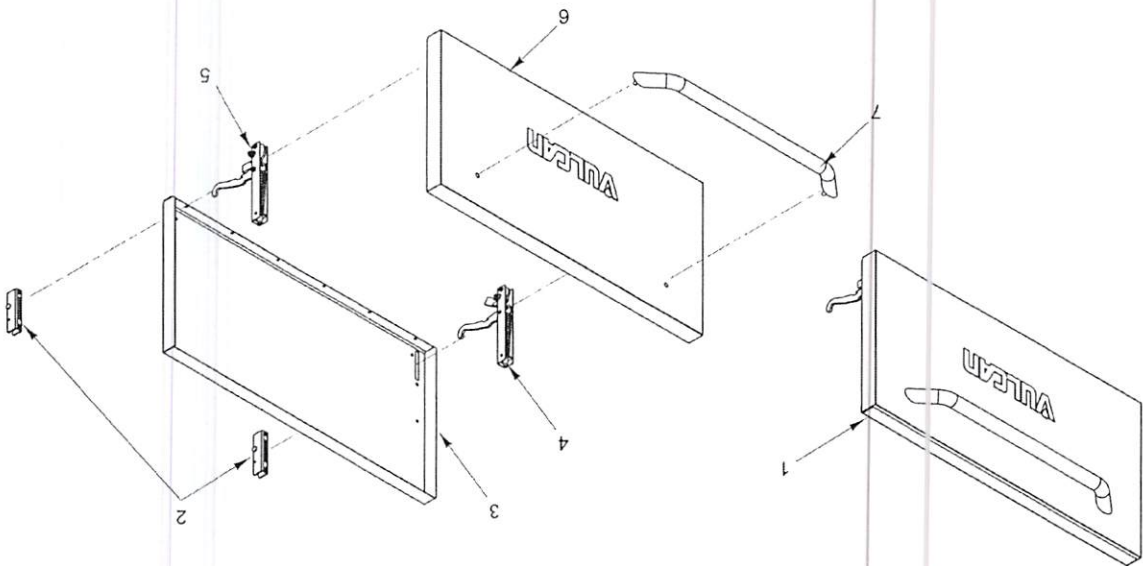

DOOR

ILLUS. PL-65027	PART NO.	NAME OF PART	AMT.
1	00-922448-0(36A	Door Assy. (SX36).....	1
2	00-961331-0(003	Stop - Door Hinge.....	2
3	00-922447-0(036	Liner - Door (SX36).....	1
4	00-961331-0(002	Hinge - LH Door.....	1
5	00-961331-0(001	Hinge - RH Door.....	1
6	00-922441-0(036	Panel - Door Outside (SX36).....	1
7	00-922423	Handle - Door.....	1
8	00-922448-0(60A	Door Assy. (SX60).....	1
9	00-922447-0(060	Liner - Door (SX60).....	1
10	00-922441-0(060	Panel - Door Outside (SX60).....	1



COVERS (SX36)

PL-65028

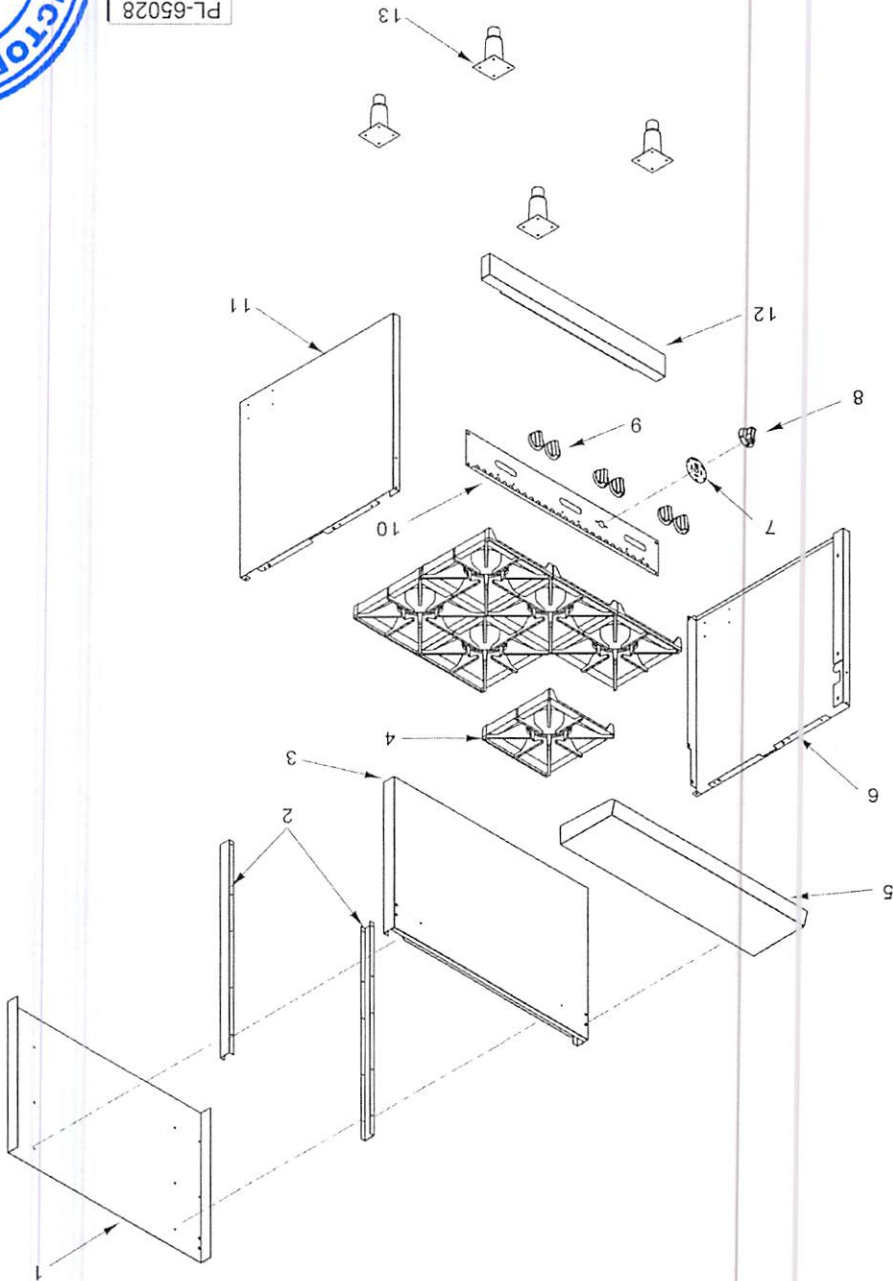

COVERS (SX36)

ILLUS.	PART NO.	NAME OF PART	AMT.
PL-65028			
1	00-922436-00036	Riser - Back (Back Panel) (SX36).....	1
2	00-922438	Support - Back Riser.....	2
3	00-922437-00036	Riser - Back (Front Panel) (SX36).....	1
4	00-925000	Grate.....	6
5	00-922439-00036	Cover - Shelf (SX36).....	1
6	00-922440-00002	Panel - LH Side (SX36).....	1
7	00-922421	Plate - Dial.....	1
8	00-961412	Knob - Oven.....	1
9	00-961411	Knob - Open Top Burner.....	6
10	00-922446-00036	Panel - Front (SX36).....	1
11	00-922440-00001	Panel - RH Side (SX36).....	1
12	00-922435-00036	Lid - Front Lower (SX36).....	1
13	00-413112-00012	Leg (6 In.).....	4



COVERS (SX60 / SX60F)

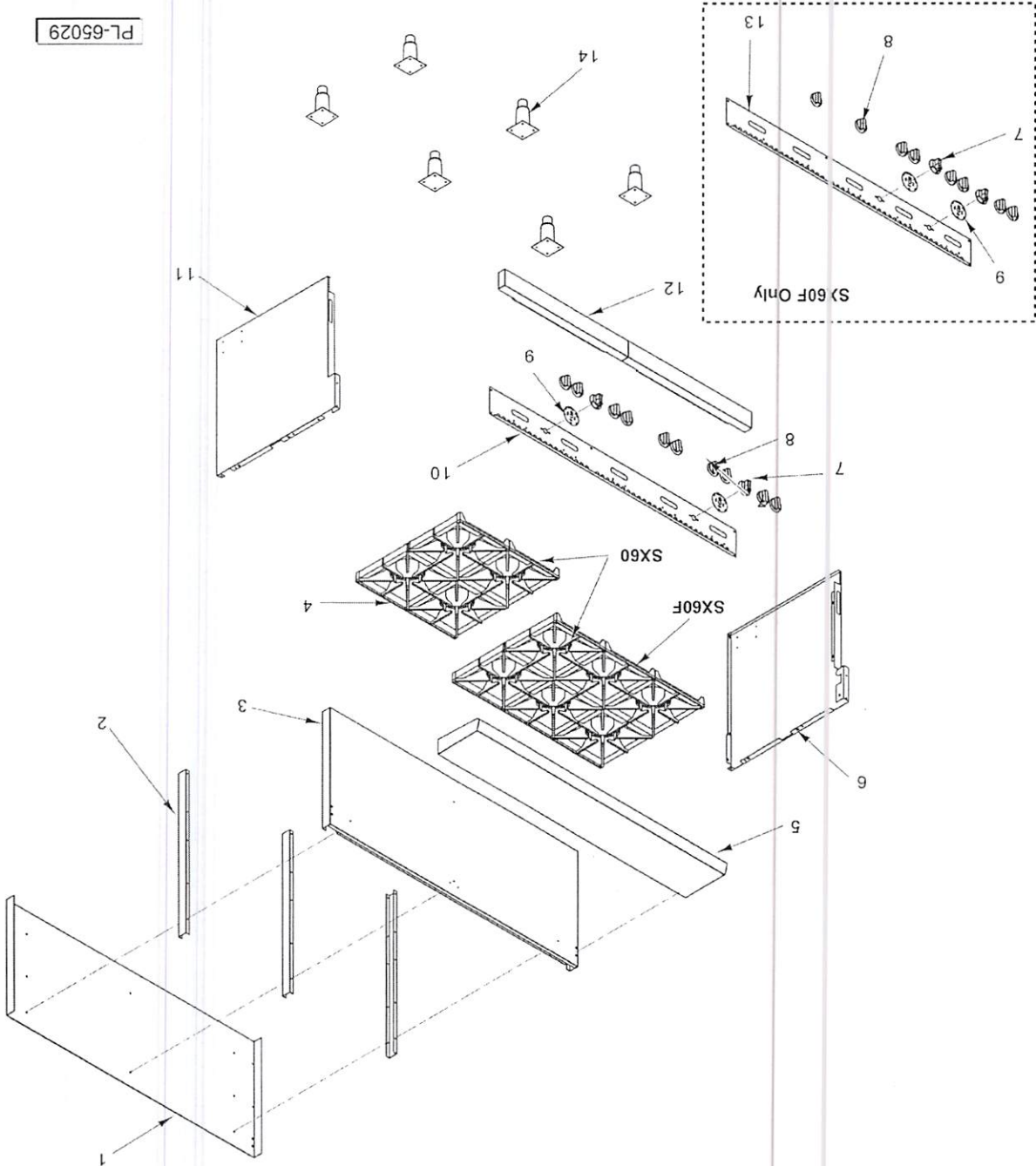

PL-65029

COVERS (SX60 / SX60F)

ILLUS. PL-65029	PART NO.	NAME OF PART	AMT.
1	00-922436-00060	Riser - Back (Back Panel) (SX60).....	1
2	00-922438	Support - Back Riser.....	3
3	00-922437-00060	Riser - Back (Front Panel (SX60).....	1
4	00-925000	Grate.....	AR
5	00-922439-00060	Cover - Shelf (SX60).....	1
6	00-922442-00002	Panel - LH Side (SX60).....	1
7	00-961412	Knob - Oven.....	2
8	00-961411	Knob - Open Top Burner.....	AR
9	00-922421	Plate - Dial.....	2
10	00-922446-00060	Panel - Front (SX60).....	1
11	00-922442-00001	Panel - RH Side (SX60).....	1
12	00-922435-00060	Lid - Front Lower (SX60).....	2
13	00-922446-0060F	Panel - Front (SX60F).....	1
14	00-413112-00012	Leg (6 In.).....	6



OVEN

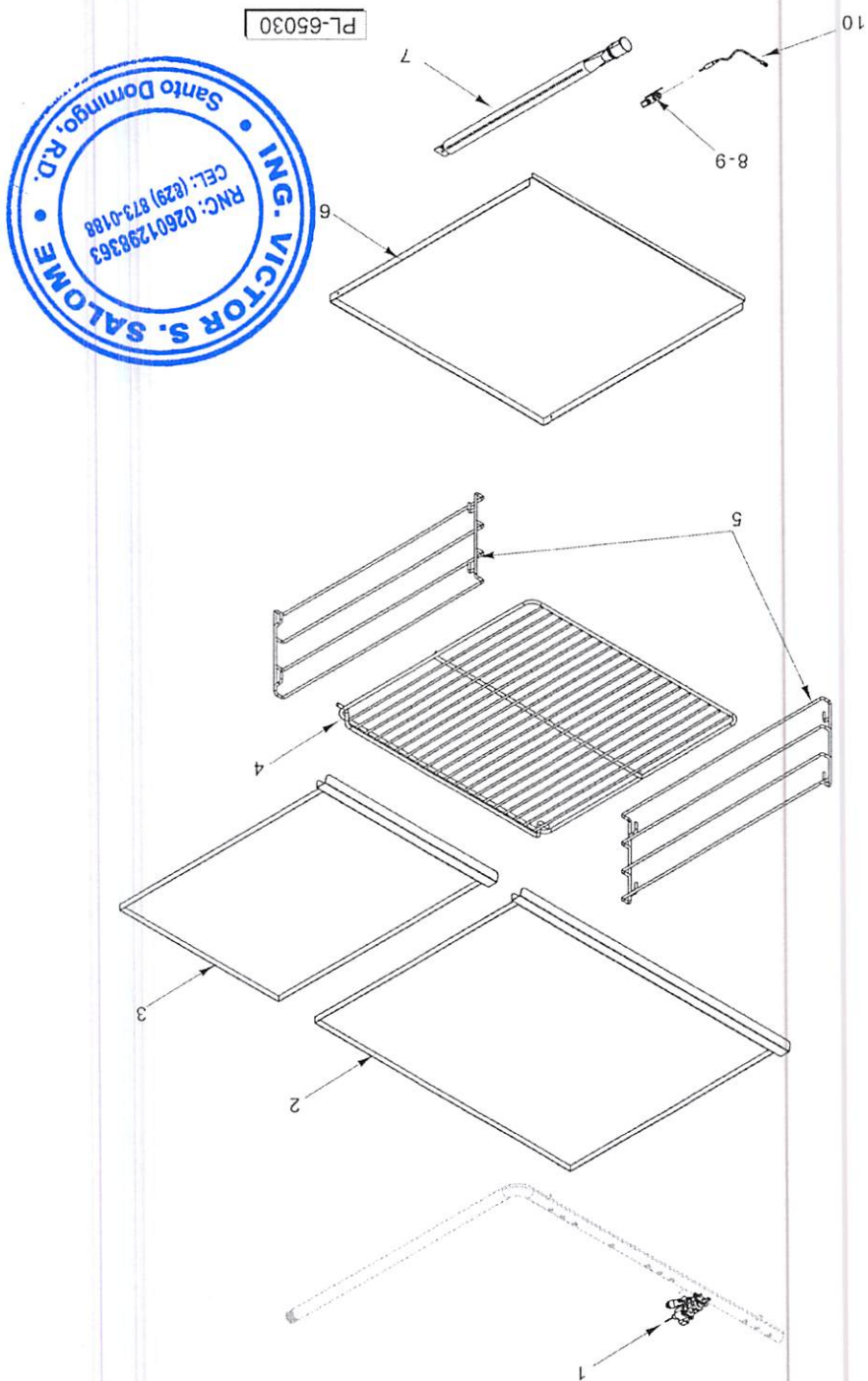

OVEN

AMT.

NAME OF PART

PART NO.

ILLUS.
PL-65030

1	Thermostat - SABAF.....	00-961330	1
1	Crumb Tray Assy.....	00-922431	2
1	Crumb Tray Assembly (SX60 Only).....	00-922432	3
1	Rack - Oven.....	00-922424	4
2	Support - Oven Rack.....	00-922425	5
1	Tray - Porcelain Oven.....	00-922429	6
1	Burner - Oven.....	00-961332	7
1	Pilot - Oven (NAT).....	00-412787-0001	8
1	Pilot - Oven (LP).....	00-412787-0002	9
1	Thermocouple.....	00-412788-00060	10



SX60F

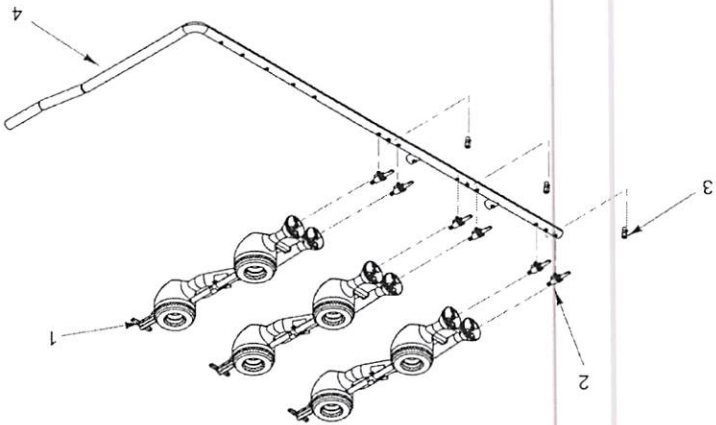

SX60

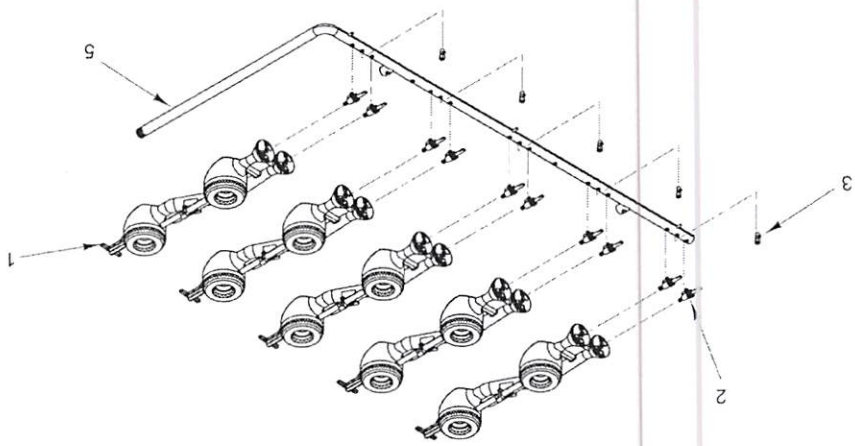

SX36

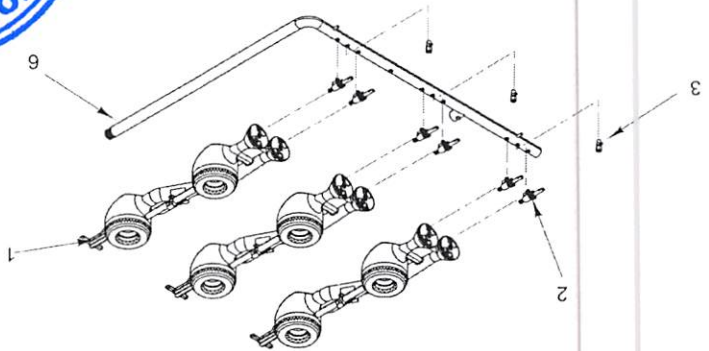

PIPING

PL-65031



PIPING

AMT.

NAME OF PART

PART NO.

ILLUS.
PL-65031

AR	Body - Oven Top Burner.....	00-928014-C000A	1
AR	Valve - Gas.....	00-961329	2
AR	Valve - Oven Top Pilot.....	00-922422	3
1	Manifold (SX60F).....	00-922426	4
1	Manifold - Gas (SX60).....	00-922428	5
1	Manifold - Gas (SX36).....	00-922427	6



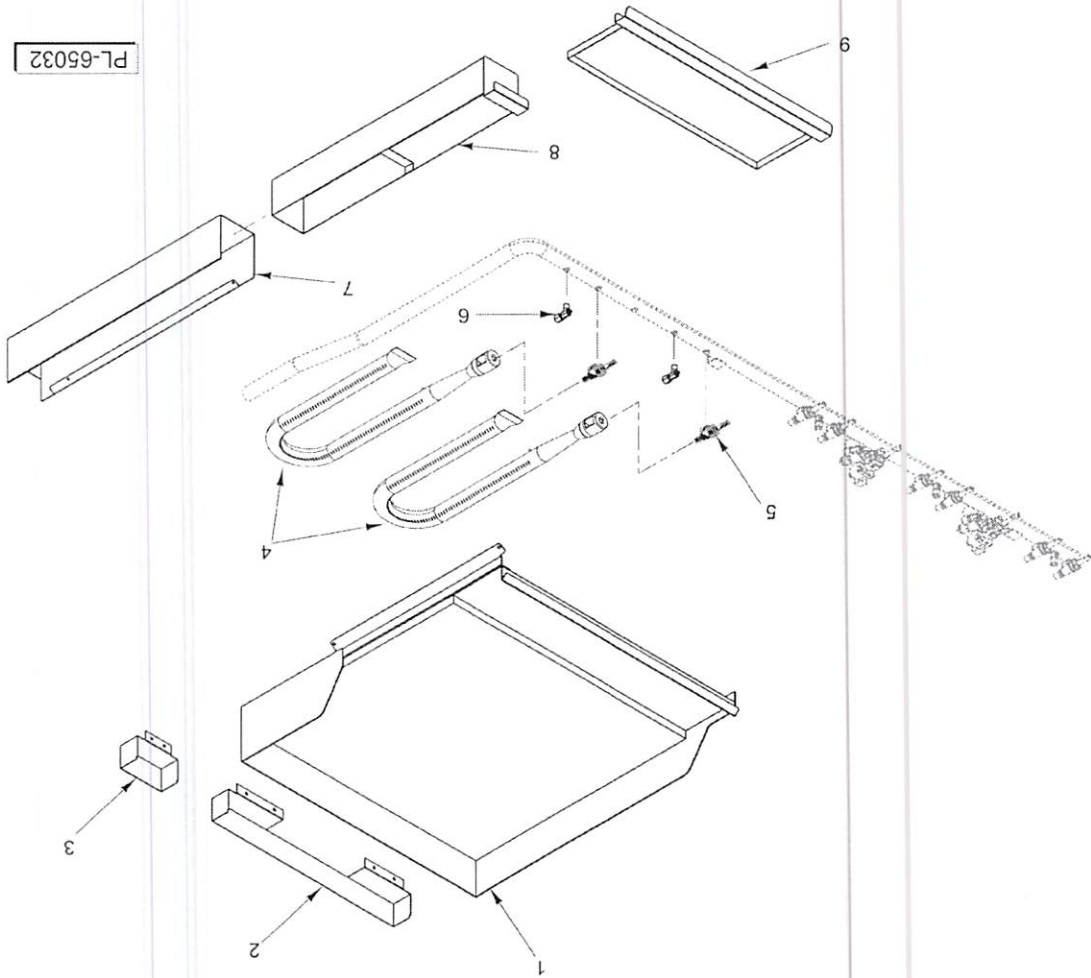

PL-65032



GRIDDLE

GRIDDLE

ILLUS.	PART NO.	NAME OF PART	AMT.
PL-65032			
1	00-922434-0000A	Griddle Plate Assy.....	1
2	00-922444-00002	Box - Griddle Flue (Large).....	1
3	00-922444-00001	Box - Griddle Flue (Small).....	1
4	00-961413	Burner - Griddle.....	2
5	00-961329	Valve - Gas.....	2
6	00-922430	Valve - Griddle Burner Pilot.....	2
7	00-922443	Support - Griddle Front Crumb Tray.....	1
8	00-922433	Griddle Tray Assy.....	1
9	00-922445	Tray - Griddle Front Crumb.....	1





RESTAURANT RANGES**VULCAN****36" SX SERIES LIGHT-DUTY RANGE
6 OPEN BURNERS**

Model SX36-6BN



Intertek

SPECIFICATIONS

36" wide SX series light-duty range, Vulcan Model No. SX36-6BN. Stainless steel front, sides, backriser, high shelf and bullnose. High temperature burner T knobs with set screw. Porcelain door liner and oven bottom. Six 28,000 BTU/hr. cast top burners with lift-off burner heads. Shrouded flash tube pilot system (one pilot per two burners). 12" x 12" cast top grates with aeration bowls. Heavy duty top grates and burner heads. Compression spring door hinge system for durability. 30,000 BTU/hr. Standard oven measures 26 $\frac{3}{4}$ "w x 26"d x 13 $\frac{3}{4}$ "h. Thermostat adjusts from 250° to 500°F. One oven rack with four rack positions. $\frac{3}{4}$ " rear gas connection and gas pressure regulator. Total input: 198,000 BTH/hr.

Exterior Dimensions:

36"w x 32"d x 58"h on 6" adjustable legs.

- ☐ SX36-6BN 1 Standard Oven / Natural Gas
- ☐ SX36-6BP 1 Standard Oven / Propane

STANDARD FEATURES

- Stainless steel front, sides, backriser, lift-off high shelf.
- 6" Stainless steel adjustable legs.
- 28,000 BTU/hr open top burners with lift-off heads.
- Shrouded flash tube pilot system (one pilot per two burners).
- 12" x 12" cast top grates with aeration bowls.
- 30,000 BTU/hr standard oven cavity measures 26 $\frac{3}{4}$ "w x 26"d x 13 $\frac{3}{4}$ "h.
- Oven thermostat adjusts from 250° to 500°F.
- One oven rack and four rack positions.
- $\frac{3}{4}$ " rear gas connection and gas pressure regulator.
- One year limited parts and labor warranty.

ACCESSORIES (Packaged & Sold Separately)

- ☐ Extra oven rack.
- ☐ Reinforced backriser and high shelf for mounting salamander broiler.
- ☐ Set of four casters (two locking).

VULCAN

a division of ITW Food Equipment Group LLC

P.O. Box 696 ■ Louisville, KY 40201 ■ Toll-free: 1-800-814-2028 ■ Local: 502-778-2791 ■ Quote & Order Fax: 1-800-444-0602



RESTAURANT RANGES

VULCAN

36" SX SERIES LIGHT-DUTY RANGE 6 OPEN BURNERS

INSTALLATION INSTRUCTIONS

1. A pressure regulator sized for this unit is included. Natural gas 5.0" W.C., propane gas 10.0" W.C.
2. Gas line connecting to range must be $\frac{3}{4}$ " or larger. If flexible connectors are used, the inside diameter must be $\frac{3}{4}$ " or larger.
3. An adequate ventilation system is required for commercial cooking equipment. Information may be obtained by writing to the National Fire Protection Association, 1 Batterymarch Park, Quincy, MA 02269, www.NFPA.org. When writing, refer to NFPA No. 96.
4. These units are manufactured for installation in accordance with ANSZ223.1A (latest edition), National Fuel Gas Code. Copies may be obtained from The American Gas Association, 400 N Capitol St. NW, Washington, DC 20001, www.AGA.org.

5. **Clearances**

	Rear	Sides
Combustible	12"	10"
Non-Combustible	6"	0"
6. For proper combustion, install equipment on adjustable legs or casters provided with unit.

NOTE: In line with its policy to continually improve its product, Vulcan reserves the right to change materials and specifications without notice.

Specify type of gas when ordering.
Specify altitude when above 2,000 feet.

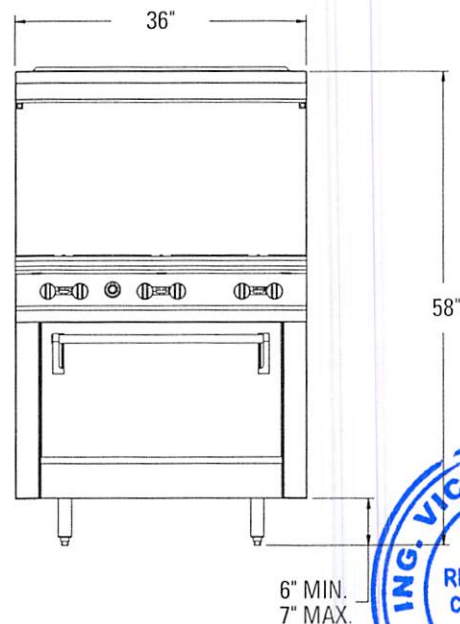
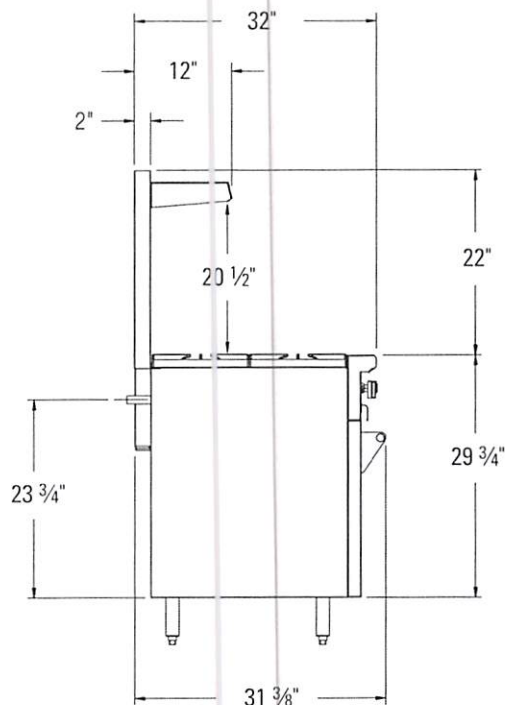

TOP CONFIGURATION	MODEL NUMBER	DESCRIPTION	TOTAL INPUT BTU / HR	SHIPPING WEIGHT LBS / KGS
	SX36-6BN	6 Burners / 1 Standard Oven / Natural Gas	198,000	456 / 207
	SX36-6BP	6 Burners / 1 Standard Oven / Propane	198,000	456 / 207

This appliance is manufactured for commercial use only and is not intended for home use.

VULCAN

a division of ITW Food Equipment Group LLC

P.O. Box 696 ■ Louisville, KY 40201 ■ Toll-free: 1-800-814-2028 ■ Local: 502-778-2791 ■ Quote & Order Fax: 1-800-444-0602

NOTE: In line with its policy to continually improve its products, Vulcan reserves the right to change materials and specifications without notice.